



System Data Sheet

Duxford Canopy

Uniclass L382	EPIC C426
CI/SfB (27.7)	X



Specification

Mild steel framework, high zinc powder coated to any standard RAL or BS colour.
Circular tubular columns chemically anchored to a suitably prepared concrete base.

UV protected structured polycarbonate glazing (with 10 year guarantee) fixed with two part glazing bar.
Glazing bars are white as standard but can be to any standard RAL or BS colour at additional charge.

Rainwater gutters are also included to both eaves with downpipes supplied to discharge at ground level.

Dimensions

All dimensions given below are typical sizes, each structure is made to suit the individual site. Please refer to the quotation for overall sizes, heights and column spacings.

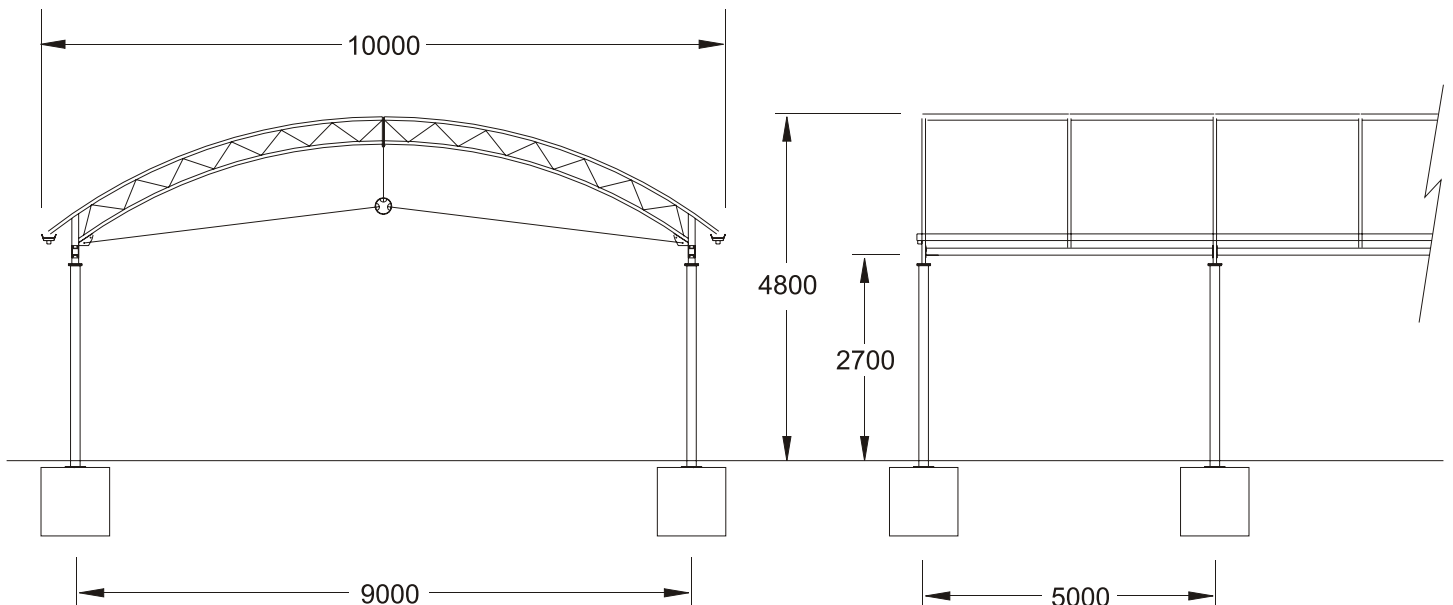

Clovis Canopies

Branbridges Road, East Peckham, Tonbridge, Kent, TN12 5HH
Tel: 01622 873900 Fax: 01622 873903
info@clovis-canopies.com www.clovis-canopies.com

Do not Scale

© Clovis Lande Associates Ltd